

**service\_team\_name** Licensing Team

**service\_email\_address** licensing@midsussex.gov.uk

**Your Details**

**Correspondence**

**Correspondence Email** niki@cuckfieldgolf.co.uk

**Confirm Email** niki@cuckfieldgolf.co.uk

**Name** Niki Smyth

**Premises licence number** PWA0321

**Premises**

**Name of premises** cuckfield golf centre

**Does your premises have a postal address?** Yes

**Postal address of premises or, if none, ordnance survey map reference or description** Cuckfield golf centre Staplefield road  
Cuckfield West Sussex RH175HY

**Tel: (at premises)** 01444-459999

**Email** niki@cuckfieldgolf.co.uk

**Non-domestic rateable value of premises.** £4301 - £33000

**Current Premises Licence**

**Please describe briefly, the nature of the proposed variation** The floor plan has changed due to renovations.

**Attach the premises licence (or relevant part of it)** [https://forms.midsussex.gov.uk/upload\\_dld.php?fileid=8434ec3c27b5a5ec2d17b76ef514cf7a](https://forms.midsussex.gov.uk/upload_dld.php?fileid=8434ec3c27b5a5ec2d17b76ef514cf7a)

**If you have not attached the premises licence or relevant part of it, please give your reasons:**

**Applicant Details**

**Current postal address if different from premises address**

**Phone**

**Email**

**Operating Schedule**

**Do you want the proposed variation to have effect as soon as possible?** Yes

**Operating Schedule**

**If the club's proposed variation would mean that 5,000 or more people are expected to attend the**

**premises at any one time, please state the number expected to attend**

**Describe the premises.  
For example the type of  
premises, its general  
situation and layout and  
any other information  
which could be relevant to  
the licensing objectives.  
Where your application  
includes off-supplies of  
alcohol and you intend to  
provide a place for  
consumption of these off-  
supplies you must include  
a description of where the  
place will be and its  
proximity to the premises.**

Golf club and restaurant used for events.

**Activities**

**Plays**

**Will you be provisioning  
Plays?**

No

**Monday**

**Tuesday**

**Wednesday**

**Thursday**

**Friday**

**Saturday**

**Sunday**

**Films**

**Will you be provisioning  
Films?**

No

**Monday**

**Tuesday**

**Wednesday**

**Thursday**

**Friday**

**Saturday**

**Sunday**

**Indoor Sports**

**Will you be provisioning  
Indoor Sporting events?**

No

**Monday**

**Tuesday**

**Wednesday**

**Thursday**

**Friday**

**Saturday**

**Sunday**

**Boxing or wrestling**

**Will you be provisioning  
boxing or wrestling  
events?**

No

**Monday**

**Tuesday**

**Wednesday**

**Thursday**

**Friday**

**Saturday**

**Sunday**

**Live Music**

**Will you be provisioning  
Live Music?**

No

**Monday**

**Tuesday**

**Wednesday**

**Thursday**

**Friday**

**Saturday**

**Sunday**

**Monday**

**Tuesday**

**Wednesday**

**Thursday**

**Friday**

**Saturday**

**Sunday**

**Monday**

**Tuesday**

**Wednesday**

**Thursday**

**Sunday**

**Where will the performance of live music take place? Indoors may include a tent.**

**Please state type of activity to be authorised, if not already stated, and give relevant further details, for example (but not exclusively) whether or not music will be amplified or unamplified.**

**State any seasonal variations for performing live music: For example (but not exclusively) where the activity will occur on additional days during the summer months.**

**Non standard timings. Where the premises intends to use the premises for the performance of live music at different times from those listed above, please list: For example (but not exclusively), where you wish the activity to go on longer on a particular day e.g. Christmas Eve.**

**Recorded Music**

**Will you be provisioning Recorded Music?**      No

**Monday**

**Tuesday**

**Wednesday**

**Thursday**

**Friday**

**Saturday**

**Sunday**

Where will the playing of recorded music take place? Indoors may include a tent.

Please state type of activity to be authorised, if not already stated, and give relevant further details, for example (but not exclusively) whether or not music will be amplified or unamplified.

State any seasonal variations for playing recorded music: For example (but not exclusively) where the activity will occur on additional days during the summer months.

Non standard timings. Where the premises intends to use the premises for the playing of recorded music at different times from those listed above, please list: For example (but not exclusively), where you wish the activity to go on longer on a particular day e.g. Christmas Eve.

**Performances of dance**

Will you be provisioning Performances of dance? No

Monday

Tuesday

Wednesday

Thursday

Friday

Saturday

Sunday

**Similar to live music, recorded music or performances of dance**

Will you be provisioning anything with a similar description to live music, recorded music or Performances of dance? No

Monday

Tuesday

Wednesday

Thursday

Friday

Saturday

Sunday

**Late Night Refreshment**

Will you be provisioning any late night refreshment? No

Monday

Tuesday

**Wednesday**

**Thursday**

**Friday**

**Saturday**

**Sunday**

**Supply of alcohol**

**Will you be provisioning any alcohol?** No

**Monday**

**Tuesday**

**Wednesday**

**Thursday**

**Friday**

**Saturday**

**Sunday**

**Where will the supplied alcohol be consumed?**

**State any seasonal variations : For example (but not exclusively) where the supply of alcohol will occur on additional days during the summer months.**

**Non standard timings. Where the premises intends to use the premises for the supply of alcohol at different times from those listed above, please list: For example (but not exclusively), where you wish the activity to go on longer on a particular day e.g. Christmas Eve.**

**Hours premises is open to the public**

**Monday**

**Tuesday**

**Wednesday**

**Thursday**

**Friday**

**Saturday**

**Sunday**

**State any seasonal variations : For example (but not exclusively) where the supply of alcohol will occur on additional days during the summer months.**

**Non standard timings. Where you intend to use the premises to be open at different times from those listed above, please list: For example (but not exclusively), where you wish the activity to go on longer on a particular day e.g. Christmas Eve.**

**Current licence conditions**

**Please identify those conditions currently imposed on the licence which you believe could be removed as a consequence of the proposed variation you are seeking.** none

**Adult Entertainment**

**Please highlight any adult entertainment or services, activities, or other entertainment or matters ancillary to the use of the premises that may give rise to concern in respect of children.**

**Licensing Objectives**

**General - all four licensing objectives (b,c,d,e):** Introducing challenge 25, provide staff training, join a pub watch group, install cctv  
**Please list here steps you**

**will take to promote all four licensing objectives together.**

**The prevention of crime and disorder:** cctv, refusal register, pub watch

**Public safety:** cctv, training

**The prevention of public nuisance:** cctv, pub watch

**The protection of children from harm:** training and challenge 25

**Submit & Pay**

**Name** Niki Smyth

**Address for correspondence associated with this application** Cuckfield golf centre Staplefield road  
cuckfield golf West Sussex RH175HY

**Phone** REDACTED

**Email** niki@cuckfieldgolf.co.uk

**Payment Ref** 1gor98brt

Amount to be paid: GBP 190

Order summary:

Item	Price	Total
Non-domestic rateable value of premises. - £4301 - £33000	£190.00	£190.00
<b>TOTAL</b>	<b>£190.00</b>	



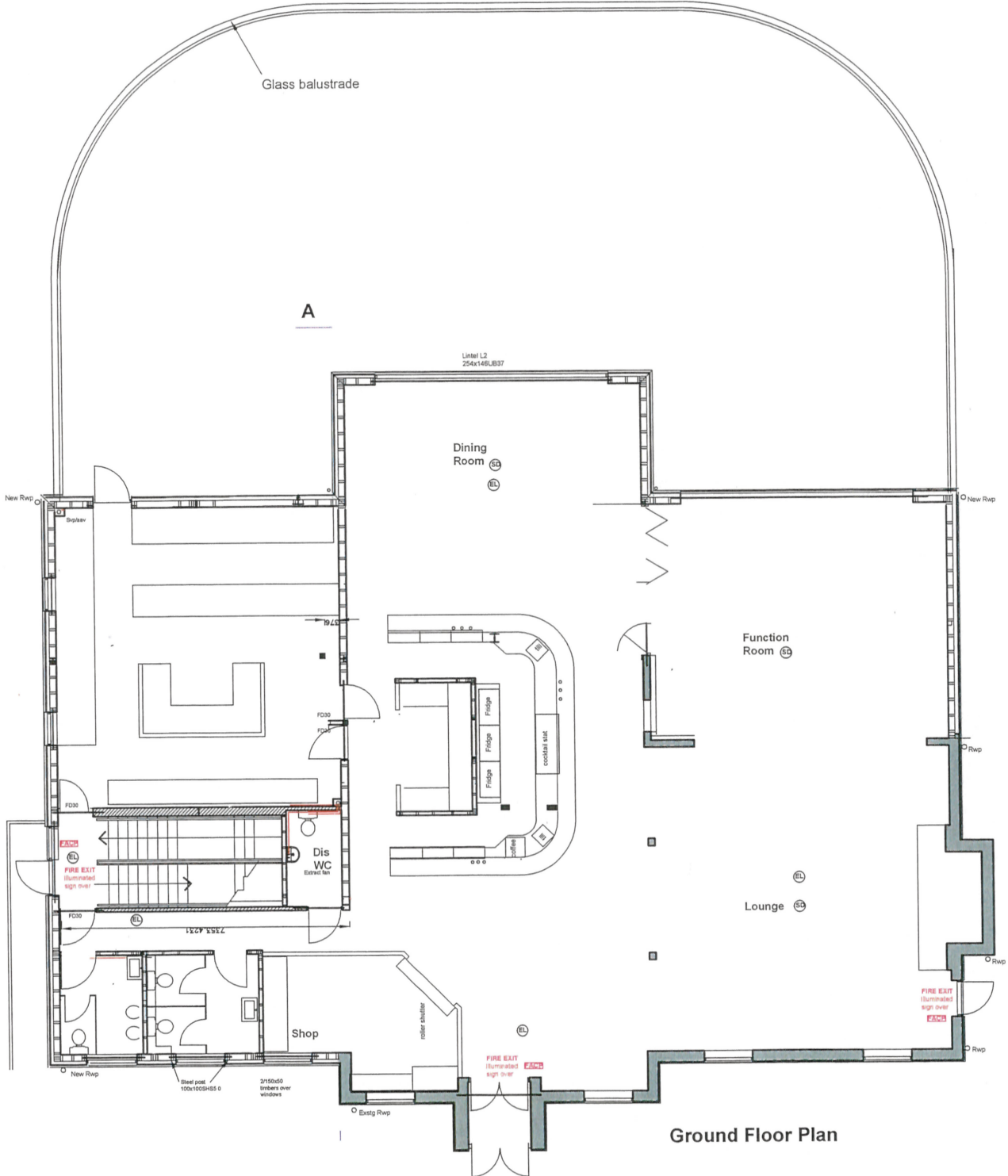

Ground Floor Plan